

Model: 071836
071853

Countertop : 309137
309154

Vintage Collection

Note : For Under Counter Sinks

Step 1 : Apply adhesive caulking around the topside of rim near the edge

See Figure 1.

Step 2 : Carefully raise sink in place, align, and press firmly

See Figure 1.

Step 3 : Attach 4 undermount clips to hold lavatory in place.

See Figure 2.

Step 4 : Secure top & back splash to cabinet by using adhesive caulk

See Figure 3.

Figure 1.

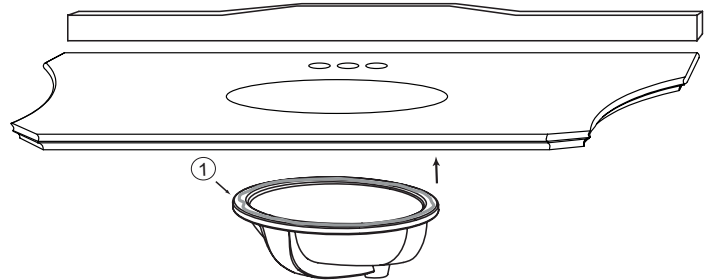

Figure 2.

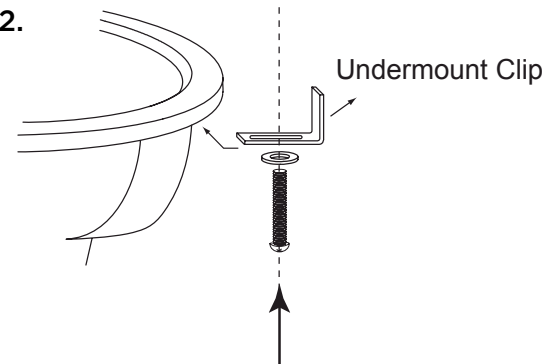

Figure 3.

